

AVAILABLE INDUSTRIAL

425 S. Countyline Street
Fostoria, Ohio 44830-1851

FEATURES:

- TOTAL SIZE 75,000 sq ft +/-
 - Office 4,800 sq ft +/-
 - Manufacturing 48,700 sq ft +/-
 - Warehouse 21,500 sq ft +/-
 - Other
- Previous Use Polymer Blow & Rotary Molding
- Year Blt/Expansions 1963/1994/2003
- Type of Construction Insulated Steel
- Roof Steel
- Clear Height
 - built 1963 - 14 ft (18,500 sf)
 - built 1994 - 24 ft (35,000 sf)
 - built 2003 - 22 ft (21,500 sf)
- Dock Doors 4 with levelers & lights
- Grade Level Doors 6
- Power 480 V/2,000 A/3P
- Special Features
 - 48,000 lb storage silo
 - Next to rail line



FOR MORE
INFORMATION
PLEASE CONTACT

Jeff Delverne
Associate
P 419.794.1116
C 419.343.1915
Jeff.delverne@cbre.com

Kevin Malinowski
Vice President
P 216.363.6411
C 216.403.8233
Kevin.malinowski@cbre.com

CB Richard Ellis | Reichle Klein
One SeaGate, 26th Floor
Toledo, OH 43604
419.861.1100



AVAILABLE INDUSTRIAL

425 S. Countyline Street
Fostoria, Ohio 44830-1851

THE OPPORTUNITY:

To acquire a 100% freehold interest in an approximately 75,000 sq ft industrial building

ASKING PRICE:

\$500,000.00

Will consider leasing

THE LOCATION:

The property is located in Fostoria, Ohio and is less than 15 miles from I-75

FOR MORE
INFORMATION
PLEASE CONTACT

Jeff Delverne

Associate
419.794.1116
Jeff.delverne@cbre.com

Kevin Malinowski

Vice President
216.363.6411
Kevin.malinowski@cbre.com

CB Richard Ellis | Reiche Klein | One SeaGate, 26th Floor | Toledo, OH 43604 |

©2009 CB Richard Ellis, Inc. The information above has been obtained from sources believed reliable. While we do not doubt its accuracy, we have not verified it and make no guarantee, warranty or representation about it. It is your responsibility to independently confirm its accuracy and completeness.

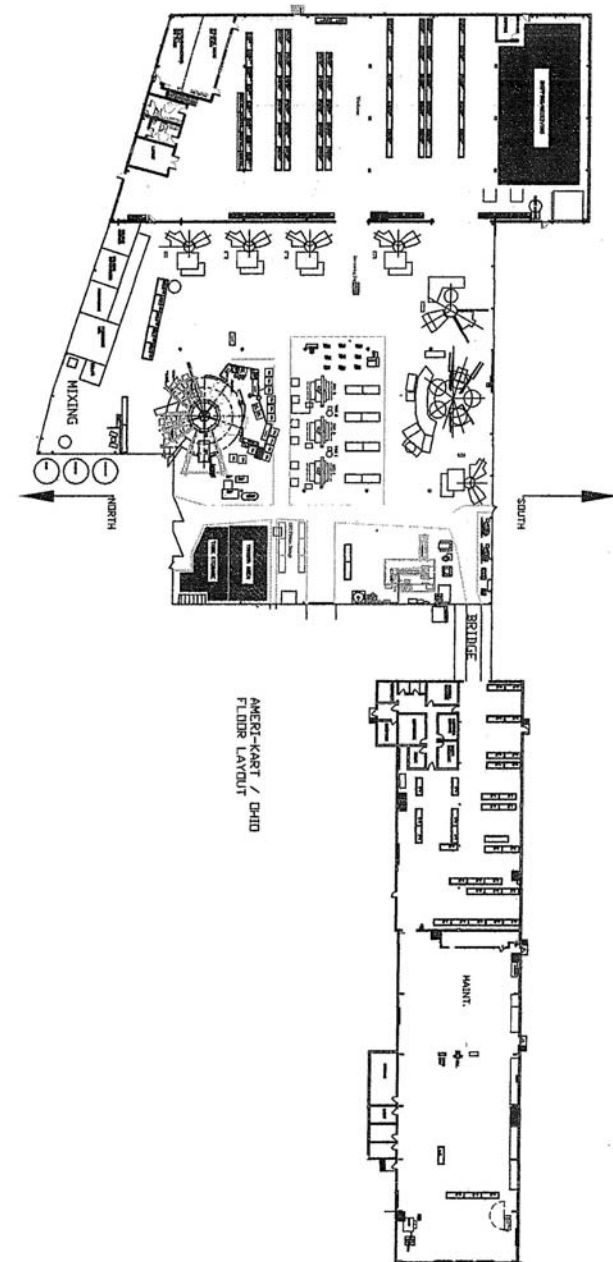

CBRE
CB RICHARD ELLIS